

BUSINESS IS A GAME. **PLAY TO WIN.**

DELTA STRIKE

LASER TAG PRODUCT RANGE

Equipment Range: 2017 to 2018



WHAT IS LASER TAG?

Laser tag is a live entertainment game where Players wear an electronic vest with an attached phaser - like this guy on the right...

The game is played inside a specially built arena - like the one shown below.

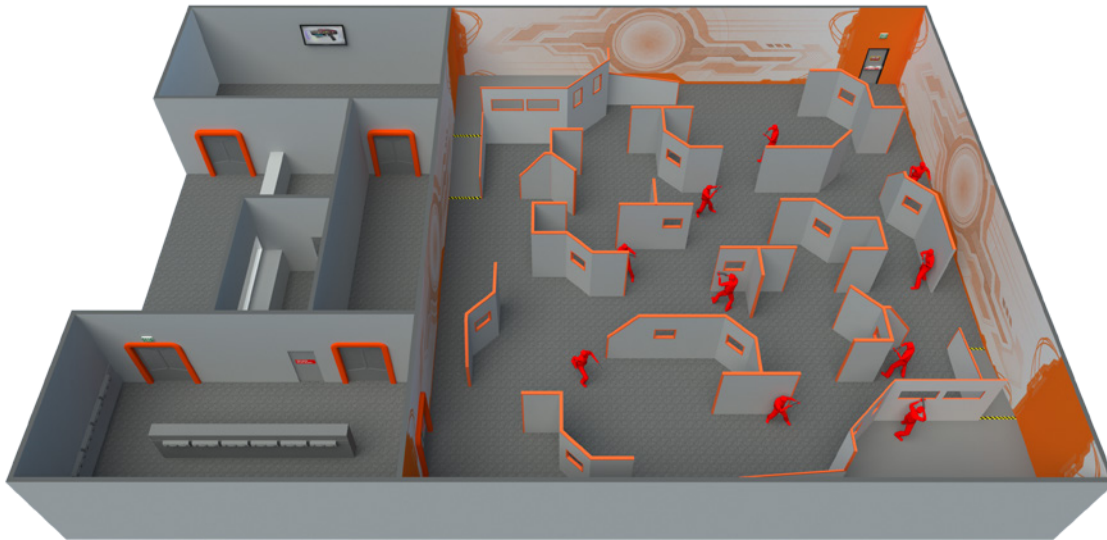

THE GAME: A laser tag game is normally 8 to 15 minutes long. There are two teams and there can be anywhere from 2 players to 40 players participating at the same time

THE EQUIPMENT: Players are equipped with a comfortable leather vest that is lit up with LED lights indicating their team color. Attached to the vest is a Phaser, which players use to tag the sensors on the opposing players vests in order to score points. At the end of the game the scores are added up (electronically) and the team with the highest score wins!

THE ARENA: Laser Tag Arenas have walls and partitions placed to create a fun and interesting place for people to hide and strategise their game play.

The playing area itself normally has low light levels with ultraviolet lights and/or LED's lighting. To create a really immersive experience, glow-in-the-dark paint, strobe lights, loud music, haze machines and interactive arena electronics are also utilized. Often the arena is highly decorated with a theme like outer space or lost temples, to create an out-of-this-world experience.

Awesome Fun!

Laser tag is a highly attractive and marketable business asset that is fun and exciting for a wide range of people; groups of friends, birthday parties, sports teams, employee team-building, school field trips and church groups, to name just a few.



Equipment Range: 2017 to 2018

CONTENTS

What Is Laser Tag?	2
Contents	3
Delta Strike History	4
Laser Tag Business Model	5
The Phaser	6
Phaser Models	8
The Vest	9
Vest Charging Cabinets	10
Remote Control	11
Arena Intelligence Modules (AIM's)	12
Base Stations and Energy Gates	14
Delta-ware Software Suite & Media Scoreboard	16
Membership	18
Game Types	19
Delta-Web Portal	20
Robust Equipment	22
After Sales Support - we're there for You!	23
Getting Started	24
Notes and Calculations	25
Mobile Laser Tag	26



DELTA STRIKE HISTORY

When former telecommunications engineer and entrepreneur Doug Willems celebrated his bachelor party at a Laser Tag venue in Christchurch, New Zealand in 2002, he could never have imagined this fun occasion would lead him to establishing a global brand, Delta Strike.



David Lowe and Doug Willems

“The Laser Tag operation was in the same building as the gym I used to go to. About a month after my stag night, instead of turning right to go to the gym, something told me to turn left and chat to the owner of the Laser Tag business instead,” says Doug.

He could see the business had become a little tired, but was still running successfully.

“I asked the owner if he’d thought about selling the Laser Tag Center, and he said he already had it on the market. It all started from that point. Three months later I was running a laser tag business

It wasn’t long before Doug realized that the Laser Tag industry as a whole was in need of some new ideas and innovations, particularly when it came to system and product design.

“The systems back then were pretty old with equipment manufactured using analog rather than digital technology. I could see the potential to design a superior Laser Tag system, so I recruited Dave Lowe (who later became a director of the company), a skilled young engineer straight out of the University of Canterbury. The two of us set out to create a new system for our center, with the idea of re-selling it at some stage in the future.”

While their earlier Laser Tag systems were successful, it wasn’t until 2012 when the Revolution and Evolution products hit the market and things really took off. Just two years later, Delta Strike was awarded the prestigious Endace Innovative High Tech Hardware Product award at the 2014 New Zealand High Tech Awards, which helped to cement their growing national and international profile.

Today Delta Strike systems are used throughout the world. With numerous industry firsts already under their belt, including the Video Base Station, the coming years will see Doug, Dave and the Delta Strike team continue to reinvent the Laser Tag industry.

LASER TAG BUSINESS MODEL

With the laser tag business model, return on investment averages 12-14 months, with some customers seeing their return in as little as 8 months.

US BASED COST ESTIMATES FOR A STANDALONE FACILITY:

Item	Costs	Notes
Laser Tag Equipment	\$ 85,000 - 110,000	30 Player system, depending on features & add-ons.
Tenant Improvements	\$ 12-14/sq.ft (\$ 110-130/sq.m)	Getting the facility ready for laser tag
Second Level Structures	\$ 20-25/sq.ft (\$215-270/sq.m)	For wooden structure.
Second Level Structures	\$ 65-80/sq.ft (\$430-540/sq.m)	For steel structure.
Professional Theming	\$ 16-25/sq.ft (\$170-215/sq.m)	Theming to arena, briefing & vesting areas.
Architecture Fees	\$ 10,000 - 20,000	
Feasability Study & Consultant	\$ 15,000 - 20,000	
Point of Sale	\$250 / month or \$15-20,000 to buy	Hardware and software for processing sales.
Exterior Signage	\$ 8,000 - 10,000	
Computers & Other Equipment	\$ 10,000	
Arcade Machines	\$ 10,000 average/game	
Utility Deposits	\$ 1,500	
Labor Costs During Training	\$ 7,500	
Permits & Licensing	\$ 2,000	
Working Capital	3 months	
Lease Deposit	2 months	
Misc Items	\$ 3,000	Trash cans, tools, office supplies, etc.

THE PHASER



Built incredibly tough and feature rich.

This phaser will stand up to the ongoing vigors of a laser tag environment whilst providing a premium laser tag experience to your customers.

BUTTONS (Pro only)

Button 1: Change weapon type:

Blaster, nuke, phaser etc - your weapon selection will change

depending on the game being played

Button 2: This button allows for other functions like reload or heal - also depends on the game being played

HIGH IMPACT CASE

Injection molded polycarbonate plastic, (three times tougher than ABS plastic) for lightweight superior strength

RUBBER NOZZLE

The rubber nozzle protects the phaser shell from damage, but more importantly also protects your customers from injury.



HAND SENSOR

Players must keep both hands on the phaser to activate it. This safety feature prevents the phaser being held out at arms length (can be deactivated if desired)

OPTICAL TRIGGER

The trigger uses an optical sensor, which means there are no switches or contacts to wear out. This ensures long life operation and less maintenance.

THE DESIGN:

At last, a phaser that looks awesome!
This futuristic space weapon looks cool enough for teenagers and friendly enough for younger children.

THE FEATURES

With this many features, players can now experience similar game-play as expected from modern video games. Games this immersive encourage repeat visits

Multi-Beam Spread

Phasers fire both narrow angle for long distance weapon simulation or wide angle short range for blaster (shotgun) style simulation



Wireless Communication

Wireless Com's allows for real time scoring, in-game powerups and unprecedented game turn around times.

Delta Strike software upgrades can also be applied without the need to open every phaser.

FRONT SPEAKER

Front Speakers designed to send strong phaser sounds towards the target player

VIBRATION FEEDBACK

Players will feel the phaser vibrate when they are being tagged, an experience similar to using a video game controller.



MEMBERSHIP (Pro System)

Players can login to their phaser with their membership card, by swiping it past the card reader on the Phaser. Membership is an optional upgrade to increase your potential income.

REAR SPEAKER

Provides gaming messages throughout the game to give feedback and help immerse players in the game.

LCD SCREEN

The LCD graphic display shows the player information about the current game, weapon, shield and points levels. It also illuminates with the players team color.



Phaser Models

Evolution **FEC**



The **Evolution FEC** has been designed for Family Entertainment Centers (FEC’s). Typically FEC’s customers are eager to play many attractions at the Center and will be less inclined to spend time learning laser tag features. As such this model has simplified game and software options and this is our easiest to operate model.

Evolution **PRO**



The **Evolution Pro** is a more advanced system that is often utilized for stand-alone laser tag venues. With laser tag as the sole attraction, these venues need the extra bells and whistles that the Pro model provides. It has to attract more customers, earn repeat business and maximize laser tag revenue.

	Evolution FEC	Evolution PRO	
Semi-Transparent Casing	✓	✓	
Internal LED Lighting	✓	✓	
Team Colors	3	9	
Game Modes	9	28+	
Compatible with all Arena Components		✓	
Narrow & Wide Infrared Modes		✓	
Buttons to Change Weapon Mode		✓	
Membership Upgrade Compatible		✓	
Game Editor Access		✓	

VIP Phaser



Players wanted a special Phaser that would set them apart- particularly the birthday children and not surprisingly, the groom on his stag night.

The VIP Phasers were introduced in 2016 and have proved to be wildly popular. Apart from looking very different, these phasers can be programmed to have their own customised sounds and weapons. The customized sounds can lead to some hilarious reactions when activated

THE VEST

Delays in vesting up players can severely impact business profitability. This vest was designed for quick easy-on, easy-off operations - especially important for large groups of players.



SHOULDER SENSORS

Each shoulder sensor has two receivers so the player can be tagged from all angles.

LEATHER VEST

The vest is designed to be highly durable, and resistant to odor build-up common in synthetic based vests.

ADJUSTABLE STRAPS

The waist straps suit customers of all ages and sizes, and allow for quick-release to reduce game turnaround times.

PHASER HOSE

Phasers are connected to the vest via a robust, reinforced rubber hose. The internal wires use a non-clamping system to prevent crimping damage and unplugging issues common in other systems.



POLYCARBONATE BODY SENSORS

Extremely durable, injection molded shells are tough enough to be driven over by a car and designed to keep clear areas from scratching.

Dazzling multicolor LED's

An array of LED's that flash, fade and pulse in brilliant patterns and colors for stunning visual effects. Up to 9 selectable team colors.

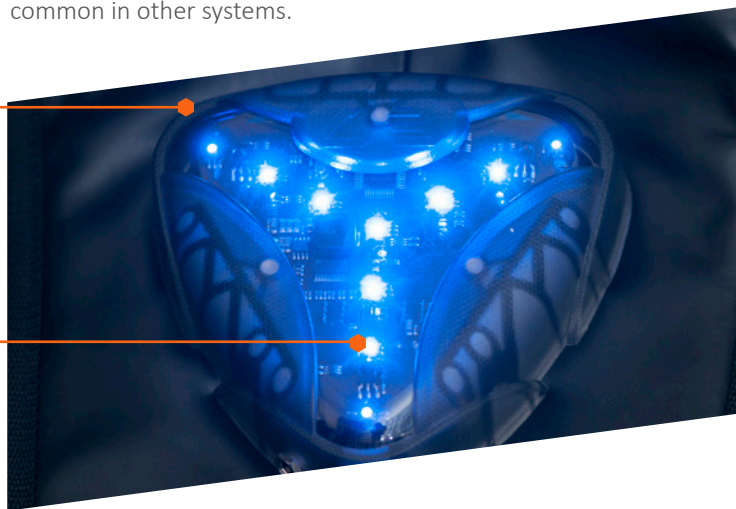

"THE PLASTICS ARE TOUGH AS NAILS AND THE VESTS STILL LOOK LIKE THEY JUST ROLLED OUT OF PRODUCTION! OF COURSE MY CUSTOMERS LOVE IT ALMOST AS MUCH AS I DO!"

RYAN MCQUILLEN, OPERATOR SINCE 1995: AIRMAXX TRAMPOLINE PARKS, USA

VEST CHARGING CABINETS

Turn the Briefing room into a stunning Light Display !



These wall-mounted cabinets look fantastic with back-lit front panels that change color to provide a slick, subdued lighting effect- not too bright, not too dull, perfect for setting a mood- almost like a movie set.

- Intelligent Chargers
- Wall-Mounted Cabinets
- Stunning Light Display

Delta Strike's intelligent chargers change color depending on the charge state. (*A great reminder to plug in packs at the end of the day.*)

Your operators will instantly know that all the packs are charging, *ensuring your packs are always ready for the next day*

The aluminium wall-mount cabinet also houses the wiring, plugs and lighting control boards. Keeps your briefing room safe and looking great

ADJUSTABLE
LED
LIGHTING



REMOTE CONTROL

This state-of-the-art Remote Control ensures incredibly fast game turnaround times and intuitive functionality.

FASTEST REMOTE IN LASER TAG! START A GAME IN 3 SIMPLE STEPS

STEP 1

Press "Sleep All" button

This ensures only players wearing a vest will be included in the upcoming game

STEP 2

Press "Game" button

This selects what game is played as well as automatically assigning team colors

STEP 3

Press "Start Game" button

This starts the game and automatically activates the equipment, special lighting, music, haze machines etc.



Infrared Pack Control:

Sweep across Players to change team colors and reset packs.



Wireless Game Control:

You can control the game and player vests from anywhere in your center.

Full Graphic Display:

Displays live game information as well as multilevel menu options

Quick Color Change:

Change packs to 1 of 9 colours directly from the Keypad

Marshall Button:

Marshall mode is used in the arena to pause, start and stop players etc

Glow-in-the Dark Keypad:

Essential when operating in a darkened vesting room.

"Stop All" Button:

Required for emergency situations. (A two 2 step process is required to ensure games are not stopped by accident)

Why the Remote is so important

Imagine 30 players all eager and excited about their upcoming game. The noise and energy in the vesting room can be overwhelming even for most experienced laser tag operators. Unfortunately, many centers rely on a computer in the vesting room to process games - **not a good idea!** This immediately separates your players from your game instructor. It also increases delays and inefficiencies

Enter the Delta Strike's custom designed remote... fast, dedicated to the purpose and intuitive to operate. Staff are now free to interact with customers instead of a computer.

With less than two minutes of training, Your operators can start and stop games!

ARENA INTELLIGENCE MODULES:

Delta Strike is pleased to announce a new range of Arena Intelligence Modules

[For release late 2017 early 2018]

For the past 2 years, the Delta Strike has been beaver-ing away at a completely new set of **Arena Intelligence Modules**. The main purpose of this upgrade was to create a range of products that looked better, sounded better and provided far more interactivity than anything else on the market.

We call these our **Arena Intelligence Modules** (or AIM's) for a good reason - they are Intelligent! Each module communicates with the Main Software to create co-ordinated and Intelligent game play within the Arena that not only works - but makes intuitive sense for the players!

SMART TARGETS

The new Smart Targets are wall-mounted modules that communicate via wifi with the Gaming Software. Depending on the game being played they have many modes of operation including:

- Bonus point target mode
- Ammunition re-fill station mode and
- Time bomb mode.

Wall Targets are designed to expand your arena's interactivity and are a recommended addition to other Arena Intelligence Modules like base stations and Energy Gates



MICRO TARGETS

The Micro Target is one of the most important additions to the Arena range. It's easy to underestimate these powerful little devices - add 20 to 40 to your arena and the fun really begins. Players Can now earn extra points by tagging a micro target whenever they see one. Different colors represent different points. Availability can vary from game to game or even during the game itself.

Micro Targets also provide fantastic fun for small groups - it's player VS player VS Arena!

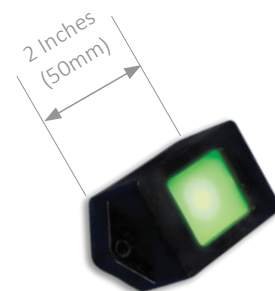

(P.S. There is a, very cool, Micro Target feature not mentioned in this brochure - ask your Delta Strike representative about this when you speak with them)

CUSTOMISED ARENA'S

Delta Strike have been involved in many **Theme-Park Laser Tag installations**. Theme-Parks require Laser Tag on Steroids!. These systems must be ultra-interactive and highly themed. There must have a creative storyline woven through the game-play. Further, the system needs to be incredibly reliable and have a very high through-put.

Although our **Intelligent Arena Modules** were designed to meet the high quality, intensity requirements of Theme-Parks, they are also available to traditional Laser Tag business's. As such - the world is your oyster! Lets take a look at some of the options...

Big Cedar - Wolf

Big Cedar used Delta Strike's Arena Comments to make their life size animal figures come alive through custom sounds and lighting patterns.

Delta Strike's **Nano Target Extensions** were the perfect size for installing into the eyes, creating a believable and interactive prop.

Other uses for the Nano targets would include turret barrels, Alien Monsters or just about anywhere that electronics remain hidden, while still providing all the gameplay functionality of the larger target modules.



Thrills - Snake Tower

Here, the multi-level arena props were perfect for building remotely triggered traps, while also making the snake head statues come alive.

Players on the ground floor can tag the Smart Target, starting the 5 second countdown after which the snake heads (complete with micro and nano extension targets) at the top of the tower tag everyone on the elevated play area. Not only does this enhance the dynamic gameplay, but it also breathes life into an otherwise lifeless prop.



Thrills - Fire Pit with Smoke

For a prop like this, we can use a tripwire module to trigger a DMX smoke machine, allowing it to erupt as a player walks past it. The Micro Targets embedded into the prop allow the player to score points, once they recover from the shock of the smoke geyser.

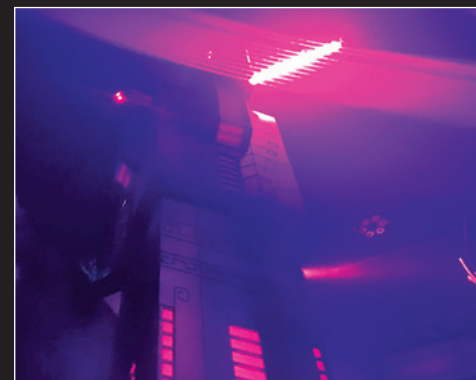

Delta Strike's Engineers are experts at making arena's come alive. If your looking for a specific theme and would like to discuss ideas around some customised functionality, feel free to call us. We'll help turn those ideas into reality.

VIDEO BASE STATIONS



High definition graphics, colorful videos and punchy audio, Customers truly love the Video Base Station!

Delta Strike's Video Base Station delivers a whole new set of video game style features into the arena. Players can gain bonus points, power-ups and special abilities, pick up special items, re-spawn into the game, reload ammunition and capture game items for their team. Laser Tag Arena's just got a lot more intelligent!

Video Base Stations also improve your customer though-put...

A problem with traditional Arena electronics is that customers don't really know what they do! As such your staff will need to take the time to explain this at the beginning of each game leading to delays in your game schedules, especially on the busy days.

The Video Base Station solves that. All the information is provided by video and audio prompts during the game itself. Essentially, the video base station becomes the instructor!

VBS GAMES:



Laserball: Laserball brings sports games to the laser battlefield. Take the ball from the middle base, and attack your way into the opposing teams half to score on their goal for bonus points! More of a sports game than combat game.



Quiz Game: Attract new customer groups by taking the focus off combat, and onto problem-solving. Players are presented with multiple choice questions and tag the target correlating to what they believe is the correct answer.



Counter Ops: One team must plant and guard the bomb at the randomly selected plant site, while the other team attempts to defend the site and disarm the bomb!
An excellent strategy game



Capture the Flag: Navigate to the other team's territory and steal their flag to take it back to your base. The flag can be passed between players, but be careful as you'll lose the flag if you're tagged by the opposing team!

ARENA INTELLIGENCE MODULES:

ENERGY GATES



Delta Strike's Energy Gates use high intensity light beams to create virtual illuminated doorways in the arena. These "gates" can be lit with any of our standard games colors.



Energy Gates are multi-purpose, For instance, when illuminated red, they will allow the red team to go through unaffected while blue players will be tagged. Other functions include re-spawn stations, power-ups and re-load gates.



In September 2017, Energy Gate modules were substantially upgraded with higher Intensity light beams, louder speakers and more advanced gaming functionality

HEX BASE STATION

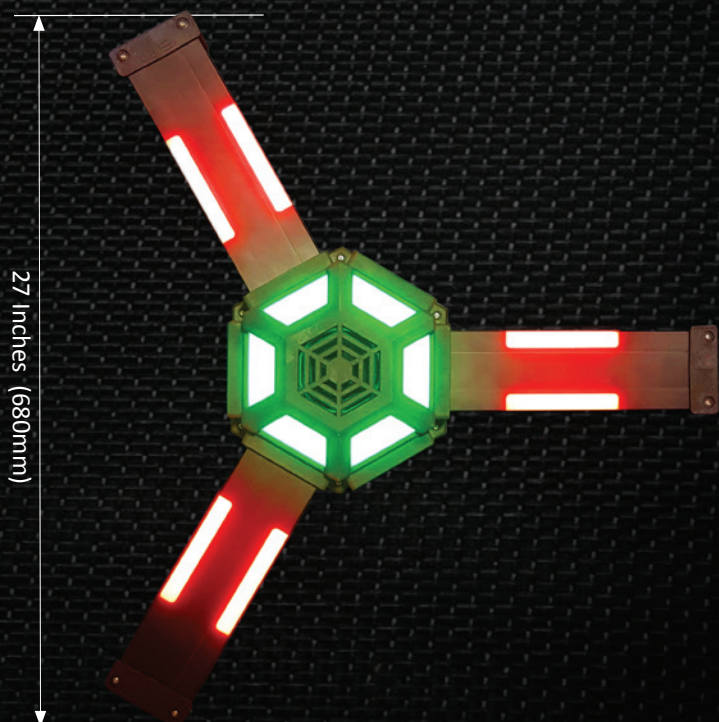

Delta Strike are delighted to announce the arrival of the new **Hex Base Station**.



With 12 individual light panels - all capable of dimming, strobing and changing color, these units span 27 Inches (680mm) from arm to arm and are designed to be noticed!

The Wall mounted "Hex" Base Stations take over from Delta Strike's previous Acrylic Base Station for a very good reason. They are brighter, louder, bigger and provide more game-play interactivity.

In fact, each arm can be tagged individually providing a game-within-a-game functionality. For instance, for 20 seconds players are challenged to tag each arm as they flash on and off randomly. Each successful hit providing additional points. This kind of functionality is particularly important to help entertain smaller groups in the Arena

Other Standard game-play functionality includes Power-ups, respawn stations, time bombs, base station capture games,

THE SOFTWARE

The Delta-Ware software suite is designed to be as easy to use as possible, From our bright, user-friendly, Windows-based interface, operators can increase or decrease current game time, change game music, set up special teams, change phaser nicknames and select game modes. The system can be as automated or as customized as you wish



The Delta-Ware software suite is run from a web browser via your local Delta server. That means:

- 1) No resource-intensive software to slow the computer down.*
- 2) A Internet Connection is not required*
- 3) Multiple computers to run the same interphacaa*

Automation - essential!

Automation in laser tag relates directly to profits. The faster you can turn games around, the more money you make per hour.

The Delta-Ware software suite automates everything from the moment you press “start game” to the end of the game when score sheets are printed.

- Activation of the Phaser packs
- Music auto-start
- Interactive Game events
- Haze or fog machines activated
- Game progress announcements
- Music auto-stop
- Phaser Packs are de-activated
- Players are notified to return
- Auto Score sheet printing
- Live Score display (monitors)

The Game Editor

The Game Editor offers countless options for operators to create their own custom weapons and power-ups New games can be created from scratch or cloned from existing games and then modified as required.

The pro level system comes with over 28 games by default, but with the game creator, an unlimited number of games can be created. Custom games are highly marketable and bring variety and interest for valued repeat customers.

MULTI-MEDIA SCOREBOARD

Your Business - Your Scoreboard!

new

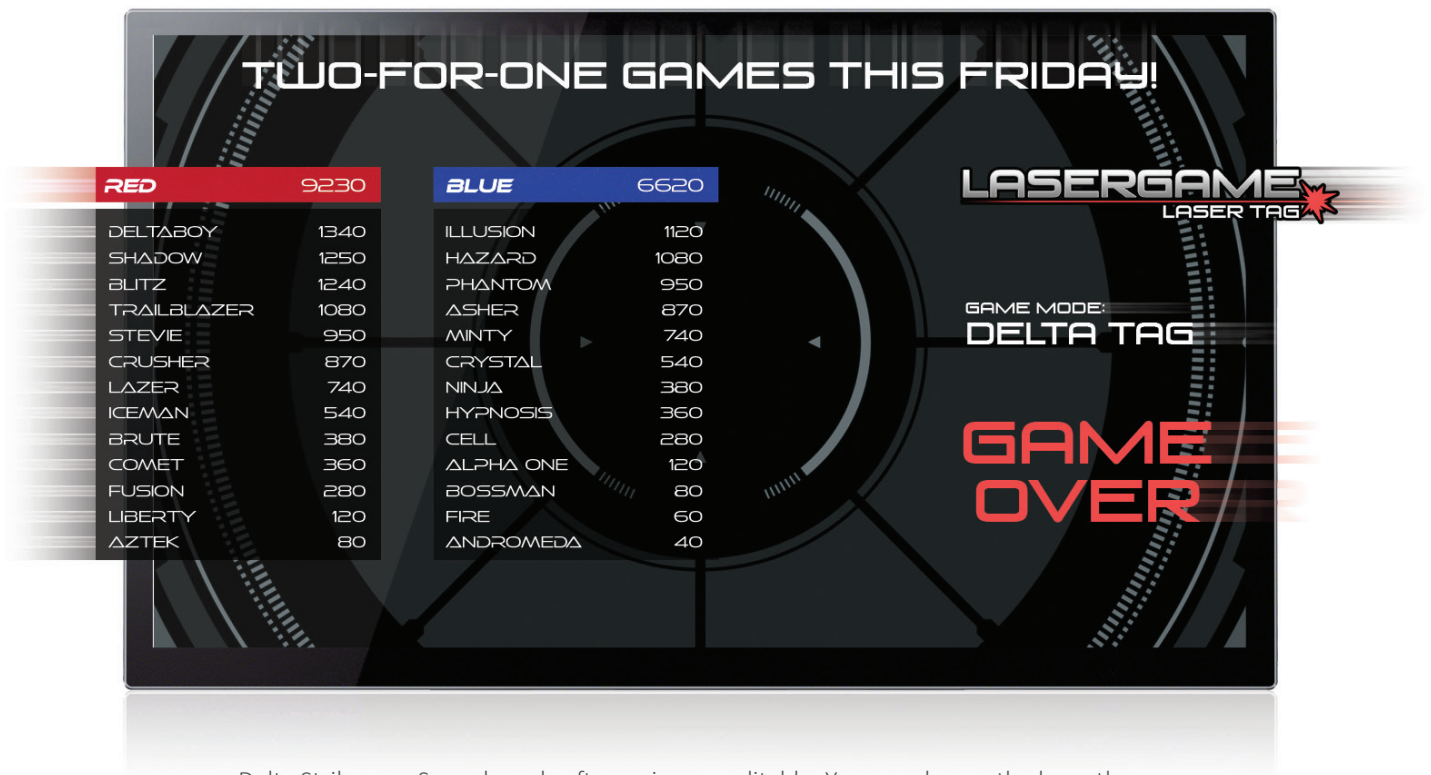

Delta Strike new Score board software is now editable. You can change the logo, the background image, the color theming, the fonts etc. In fact, it's not just a single page, it's a slide show that has many pages, each with their own editable content.

Delta Strike's software comes with five standard templates you can choose from. Each can be adjusted and modified to suit the branding identity of your center. The drag and drop editor, allows you to display:

- Score tables and graphs
- Game countdowns and information
- Promotional images and videos
- Video feed from third-party cameras inside the arena
- Scrolling text messages

Take advantage of a captive audience by running promotional videos or graphics for deals and specials within the business.

Why the scoreboard is so important:

The Scoreboard creates a friendly, yet competitive gathering point for customers- both before and after games. This promotes comradery and encourages repeat business.

Additionally, the scoreboard provides a live feed of gaming information to the reception for parents and friends to view while games in progress

MEMBERSHIP

**Membership is enticing and compelling.
More importantly, it encourages repeat business**



It's the competition that makes membership work. It starts when a player realizes that their friend has access to all the extras.... extra weapons, extra upgrades and extra games.

So The profit cycle begins. That Player is inspired to join Membership. They join, have a game and realize they will need more points to get access the really

good extras. More games required!

It's that ongoing competition that ensures repeat business for you as the owner/operator. The Membership leader-board keeps Members in touch with who has the most points.

You can further fuel that repeat business by advertising special members nights and releasing special games on a regular basis.

The Profit Cycle

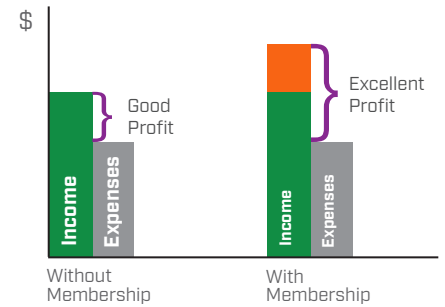

How Membership Works



The Member signs-up using the Membership software and receives a RFID Membership Card

The Member log's back into the Membership S/W and uses their experience points to upgrade their Character's Profile

The Member log's onto their phaser, their character name is displayed on the screen. During the game, they earn experience points

Games Statistics are uploaded from the Phaser to the Membership database during the game



40+ GAME STYLES

Some of the most exciting laser tag games on the planet!
On your busiest days we would recommend easy games that are quick to learn and easy to play. For special events and members nights, crank-up some of the hugely popular strategy games



GLADIATORS

Level up by scoring points to gain stronger shields and weapons. Be careful, because you will be demoted if you lose points!



GRAFFITI

Tag arena components to capture them for your team. Earn points for each second they are under your team's control.

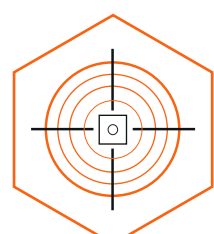

SHARPSHOOTER

Test your aim in this mode where the smallest sensors - the shoulders, are worth more points for tagging than all other sensors.



DELTA TAG

The classic laser tag game where two or more teams battle it out and tag opposing players to score points. The team with the most points is the winner at the end of the game time.



FREE FOR ALL

Players try their luck on their own against all of their friends. May the best player win!



AGENTS

Capture and keep the intelligence to earn points over time, and stop other players from stealing it from you!



AMMO TAG

Players phasers use virtual ammunition. Remember to keep an eye on your ammo and reload in time!

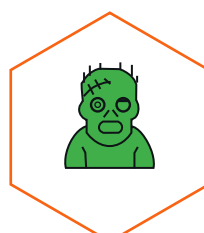

ZOMBIES

Avoid being infected by the Zombies as they attempt to convert all humans to the un-dead side!



TERRITORIES

Capture and protect the base stations to earn points for every second that they are under your team's control.



WEB-PORTAL

new



The Web-Portal is essential for owners who are not at their Center every day. You can

log-in from anywhere and get detailed and customizable reports on the condition of your equipment as well as statistics on games being played.

Operational Reports

Get to know exactly how many games are played on a daily, weekly or monthly basis.

Operational Reports allows you to create customizable reports detailing what game types were played, how players were in that game, what time the game started and finished, etc.

This module provides detailed insight into your business operations - perfect for marketing and staff scheduling.



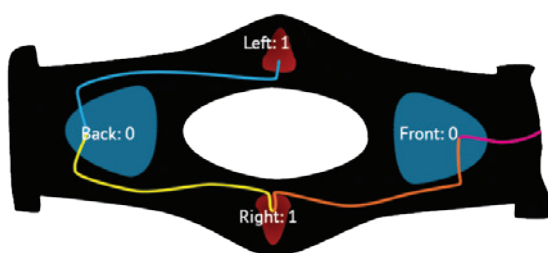
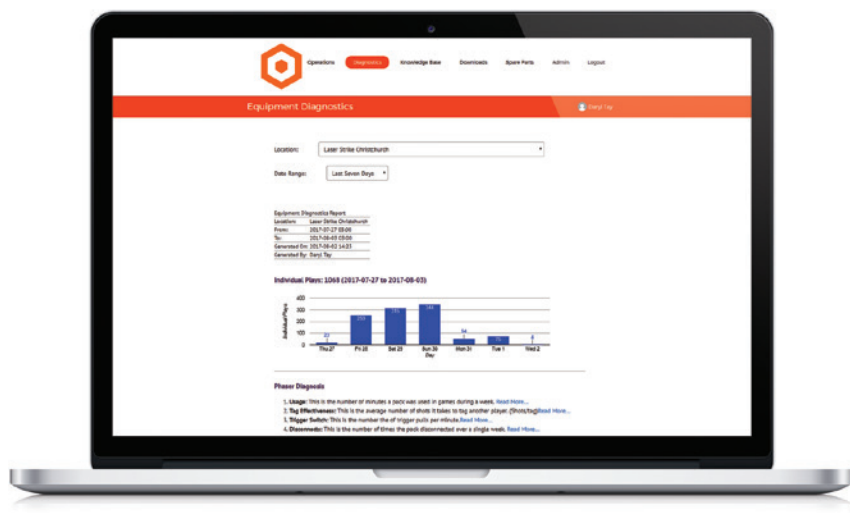

Equipment Diagnostics

A faulty phaser pack is lost income. This is why Delta Strike created the **Equipment Diagnostics Module**. This module uses statistical operational data to warn of potential equipment issues. Up to date graphs, tables and graphics provide invaluable insights into your laser tag operations.

Log-in and you will see a list of all equipment at your Center. If there are anomalies with a specific phaser pack, the system will present what the possible faults could be as well as the corresponding solutions.

Get to know:

- How often each pack is being used
- Communication issues on packs
- Suspected faulty parts
- Repeated faults
- Suggested actions to take to remedy faults and prevent downtime

Spare Parts Order Module

A common problem with many laser tag companies is not having spare parts when a phaser pack becomes faulty. If it can't be fixed, it won't be earning money!

The Delta-Portal has a Spare Parts module that allows you to order spare parts from anywhere... in the repair room, at reception or even from home!

The Spare Parts Module also has an "Inventory Mode". Here your staff can enter quantities of spare parts in your repair room and once completed an auto-order will be generated against a recommended minimum quantities. Final adjustments can be made manually as required.

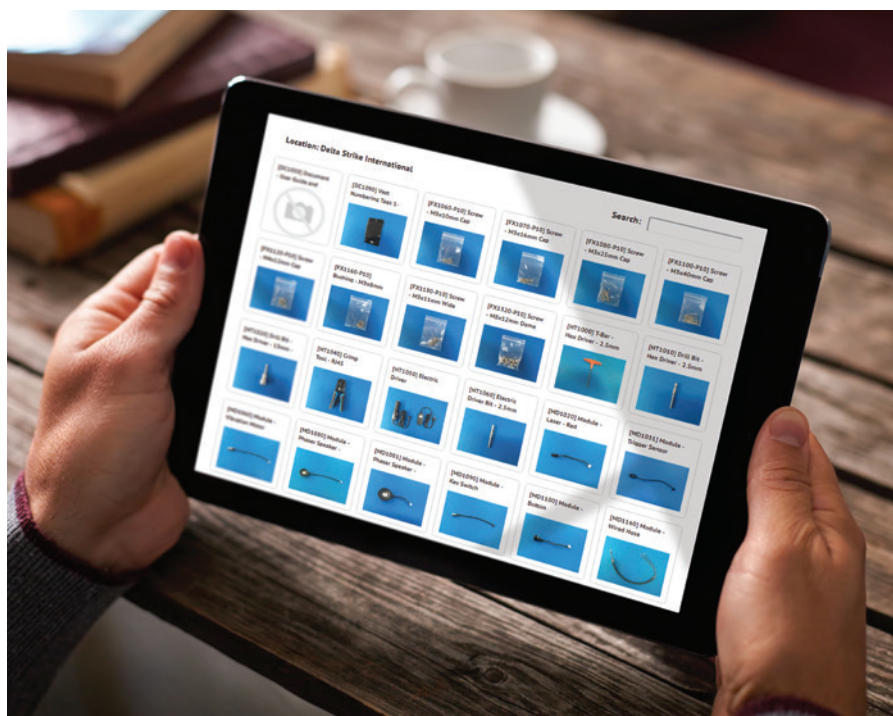

ROBUST EQUIPMENT

We at Delta Strike have owned and operated laser tag businesses. We understand that non-functioning equipment equates to lost income. Robust, reliable equipment is a must.



Delta Strike equipment carries a 2-year warranty on products which have a defect in material and workmanship under normal operating conditions.



Quality Control

We test our equipment before it gets to the final Quality Control check prior to shipping:

- Impact test: for durability
- Drop test: for durability
- Run-in test: for general operation
- Battery test: for battery life
- Many more tests

Delta Strike Equipment goes through many stages of quality control, resulting in world-class reliability. As part of the design testing, our phaser packs has been driven over with SUV's, thrown from a second story building onto a concrete pavement and smashed continuously against hard surfaces. In all cases, the equipment continued to operate as normal. For the operator, this means peace of mind that the equipment is incredibly durable.

Reliable equipment equates to minimized downtime, happy customers, and repeat business. Many design considerations have been implemented to ensure the system is durable, and any issues are easy to correct.

- Optical Trigger
- Flexible Vest to Hose cable
- Secure Plug and Play components
- Capacitive Hand Sensor
- Injection Molded Casing
- Shock Absorbing Components
- Ribbed Internal Casing for Reinforcement
- Shock Detector to Prevent Misuse.
- No Technical or engineering skills required

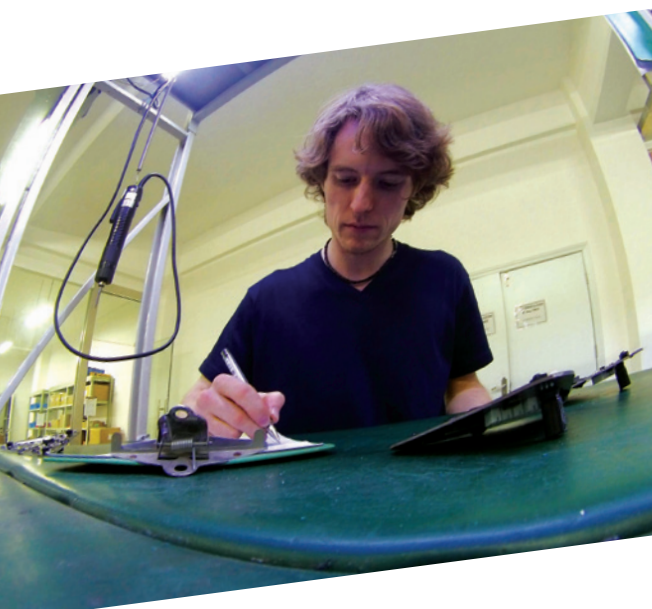

WE'RE THERE FOR YOU!

If a problem does occur, we have all the systems in place to ensure your operators are able to resolve them quickly.



DIAGNOSTICS

Check **online** to find out if all equipment is operational! The Web-Portal has a diagnostics section that keeps you in the "know." You can view up to date reports and graphs detailing game and equipment statistics. The system also provides fault remedies for suspected equipment issues.



ONLINE TRAINING

Operators have access to training videos detailing how to both operate and repair the equipment. This is especially important when training new staff. Operators simply log-in and train-up with our easy to follow training videos and articles. A Technician Certification program is also provided to enable warranty repairs are being carried out.

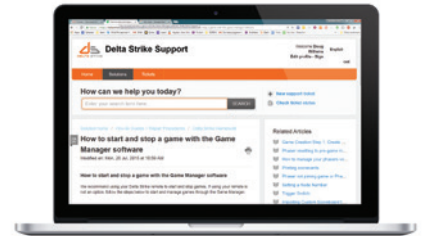

KNOWLEDGE BASE

The on-line knowledge base covers a wide variety of issues and common repair jobs. With step-by-step fixes and many instructional videos, the knowledge base is the first step in solving any maintenance issues. Operators and staff can follow along with instructions, and then contact our support staff if they still have concerns.



PLUG AND PLAY

Minimize equipment downtime with our plug-and-play, labeled components. All equipment components plug into the phaser via labeled sockets. No repair experience is necessary. Staff simply unplug faulty components and plug in a replacement!

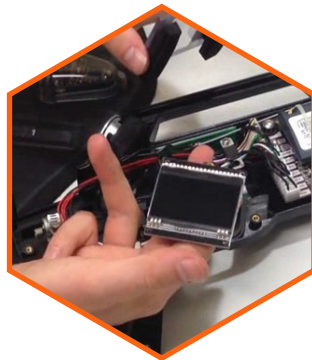

TRAINING SESSION

During the installation visit, our friendly installers will setup and configure the Delta Strike system on-site. They will also take the staff members through an extensive training session on both operating and maintaining the equipment.



24-HOUR SUPPORT

Delta Strike's 24-hour support network is available for ongoing assistance. If you call outside of standard working hours, your call will be directed to the nearest support team operator. We also have a support ticketing system, so all of our technicians have access to all customer requests at any time.

LET'S HELP YOU GET STARTED!

So much to do! How can we help you?

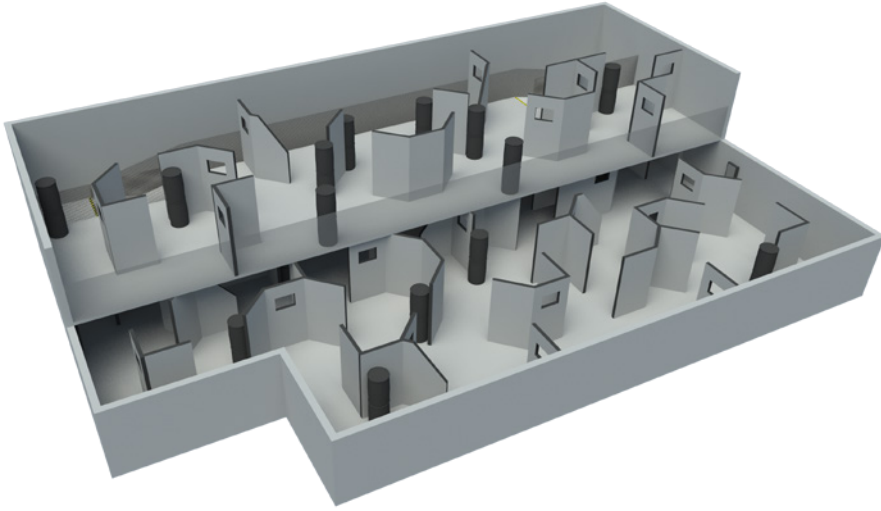

Arena Design

With extensive laser tag arena design experience, our in-house designers are happy to share their industry experience and deliver you a customized arena design based on your floor plans.

This includes the optimal positioning of equipment rooms, briefing areas, membership areas, repair room, as well as the playing arena itself. (Conditions apply)

Your own Pre-Installation Project Manager

Your laser tag project will be assigned to a dedicated project manager, who will provide you with a detailed checklist of site preparation tasks, and work with you and any other contractors to ensure you are ready for the installation of your Delta Strike equipment.



Installation & Training

Once your equipment has been delivered, Delta Strike installs and test the system and provide training to the relevant staff members. If your staff leave, or you just want current staff refreshed on their knowledge, we have extensive video training and a certification system on our website.

Downloads Section

Hit the ground running! Before your center even opens you can start getting marketing and business systems content up and running. You will have access to all of our shared media, including briefing videos, game instruction videos, promotional videos, photoshop templates, promotional photos, and various operational forms and templates.



My Notes and Calculations:

FLOOR SPACE REQUIREMENTS:

Room	sq. ft/pack	sq.m/pack
Arena	125-150	12-14
Briefing Room	8-10	0.75-1
Vesting Room	13-15	1.2-1.5

Good to know considerations

Population Base within 30 minute drive:

How far is closest competition:

Qty of Competitors within 30 miles:

How large is my building:

Will the arena be 1 or 2 levels:

What is the area of the arena:

Do I have building Plans yet:

Will I have both a vesting & briefing rooms:

Do I have a budget: \$

What is the Address:

REVENUE PROJECTION WORKSHEET:

Number of Packs	
x Number of Open Hours (Daily)	
x Number of Games Per Hour (Daily)	
x Ticket Price (Single Game)	
x 30% (Average capacity)	
x 0.85% (for discounts)	.
For the year	x365
TOTAL PROJECTION:	

Will I include other entertainment services:

if yes what are they:

Do I have a business Plan:

When is my Centers proposed opening date:

Do I have regional approval:

Are there other business Partners:

If yes who:

Will I need a loan:

If yes, how much:

What are my biggest Road Blocks:

MOBILE LASER TAG

Mobile laser tag - done the professional way!

A mobile laser tag system needs to be very light and easy to move around, quick to set-up and consistently reliable. Delta Strike's mobile system fits the bill perfectly.

Scoreboard Screen

Scoreboard software displays a stunning visual representation of post-game statistics, ready for players to view as soon as they are done with their session.

wifi Game Control

Communicate with the main computer and remote control wirelessly for easy game control and hassle-free setup.

INCLUDES GAME
REMOTE CONTROL

Charging Status

LED display panel on the front of the case notifies you which phasers are ready for action. (Plugs into an outlet for automated charging.)

Game Software

Delta Strike's game management software controls and displays game operations, fully automated and very simple to use.

Store and Charge

When phasers are placed in their storage holsters, they will automatically start charging. Perfect for continuous gaming!

Wireless Phasers

Mobile phasers communicate wirelessly and operate without a typical laser tag vest. Phasers can be tagged on the front and sides, and can be adjusted to work in light or dark conditions.

Phasers are fully charged in 4-5 hours, and deliver 6-8 hours of game play. Phasers can also be charged in between games!



Construction & Mobility

Constructed from aluminium, the mobile system is strong, light and looks fantastic!

The mobile is designed to:

- Stay inside your center and wheeled out for use when required or
- Out on the road as a mobile laser tag Service

With four locking wheels and measuring 36" x 19" x 27" / 91cm x 48cm x 68cm, the unit can be wheeled from a vehicle to your playing area with ease. Setup a laser tag game virtually anywhere!



Take Your Business on the Road

When used in conjunction with an inflatable playing arena you can fit an entire laser tag business inside a vehicle!

Bring the business to your customers, and deliver laser tag to sports clubs, schools, churches, parks- anywhere with a flat safe area to set up!

For operators who also have a fixed location business, the mobile system can serve as a marketing piece for the main business.

The mobile system includes:

- ◆ **Mobile Command Station - locking case with mobility wheels**
- ◆ **12x Phasers and Holster Chargers (with Charging Status panels)**
- ◆ **1x Remote Control (featured on page 11)**
- ◆ **1x Game Control Software license (featured on page 16)**
- ◆ **1x WI-Fi Access Point for connectivity & coverage**
- ◆ **1x Spare Parts Kit**



Operating a mobile laser tag business saves you money on rent and utilities, while maintaining the ability to offer fun & flexible laser tag gaming experiences to your customers.

A man with a beard, wearing a white shirt, black tie, and black suit jacket, is shown from the chest up. He is wearing a black tactical vest over his suit. On his shoulders and chest are several electronic components, including what appear to be small circuit boards with red LEDs. The background is dark and out of focus.

BUSINESS IS A GAME.
PLAY TO WIN.



For International inquiries please phone:
USA +1 888 538 2519 or NZ +64 982 9892

Or visit
www.deltastrike.com